

The Centre for Sustainable Energy (CSE) is an independent national charity working since 1979 to tackle the threat of climate change and to end the misery of cold homes.

We began life in Bristol in 1979 as a pioneering community organisation promoting sustainable energy and home energy advice. Over 30 years on, CSE continues to promote sustainable energy policy and practice through local and national programmes.

CSE is a leading expert in community-led sustainable energy and low carbon planning. We have extensive experience of working with community groups, local authorities and other organisations on energy issues.



CSE community training on solar PV in Bristol, 2011

### Quotes from our clients

*"I think the difference between CSE and others is that whilst you understand the policy and technologies, you have real experience on the ground so you build confidence that communities can understand the agenda, and anyone can turn to renewables on their patch"*

Planning Advisory Service on CSE's low carbon planning workshop at their event for planning officers

*"It would have taken months of research to have achieved this myself."*

*"The free resource pack explains all of the issues that a community would need to explore ... it's just really damn good."*

*"Constant discovery of well-informed insights ... the section on getting community involvement gave me some much needed insights."*

PlanLoCaL community training participants, Dec 2010

### Resources

CSE is pioneering new tools and approaches to involving communities in low carbon planning policy and community-led renewables.

Our free online resources include:

- Solar PV checklist: questions to ask installers
- Guidance on holding an energy day
- Solar boat workshop
- How to energy audit a community building
- Fair deal feed-in tariffs
- Common concerns about wind power
- Community energy event: creating your own kit
- Advice leaflets on energy use

**[www.cse.org.uk/tools-for-community-groups](http://www.cse.org.uk/tools-for-community-groups)**

**[www.cse.org.uk/adviceleaflets](http://www.cse.org.uk/adviceleaflets)**

CSE has created a highly-acclaimed resources pack for communities planning renewable energy projects. This includes 47 short films (covering technologies, case studies and project management), planning exercises, event templates and an image bank.

The full PlanLoCaL pack can be downloaded or ordered in hard copy for free.

**Resource pack: [www.planlocal.org.uk/downloads](http://www.planlocal.org.uk/downloads)**

**Films: [www.planlocal.org.uk/videos](http://www.planlocal.org.uk/videos)**

The PlanLoCaL website provides a wealth of information to help communities get involved in local planning policy and make links between low carbon living and other local priorities.

**Website: [www.planlocal.org.uk](http://www.planlocal.org.uk)**

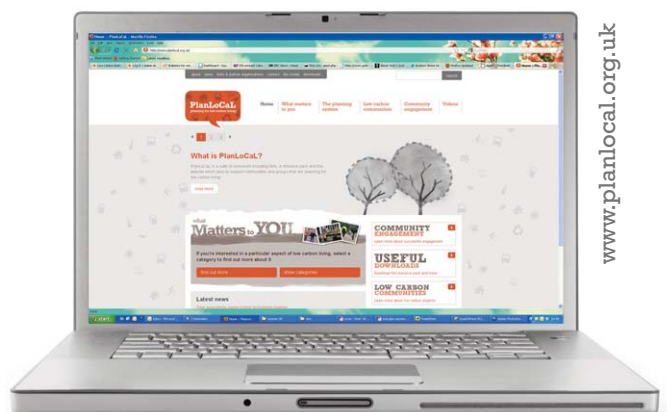



CSE's PlanLoCaL model helps people to consider options for sustainable energy in their local area, with a particular focus on community scale projects.

## Training

CSE offers both introductory and advanced training for community groups interested in running a sustainable energy project who need help with getting started or require specialist support to make their projects more effective.

Topics include:

- Managing a community energy project
- Renewable energy technologies
- Basic renewables feasibility studies
- Energy auditing
- Practical workshops (e.g. draught proofing)
- Community consultation
- Finance and funding
- The planning system and planning permission
- The Green Deal and communities
- Legal and governance structures.

CSE runs open training days as part of our funded programmes. For the latest information, visit our website or contact our communities team (see below). We also offer bespoke courses tailored to the needs of different groups, but will usually need to charge for these.

Through our PlanLoCaL programme, we have developed a 4.0m x 0.8m model to help exploration of the opportunities for sustainable energy in an urban and rural landscape. This can be hired for a fee or used as part of training sessions.

Find out more about it at  
[www.planlocal.org.uk/pages/the-model](http://www.planlocal.org.uk/pages/the-model)

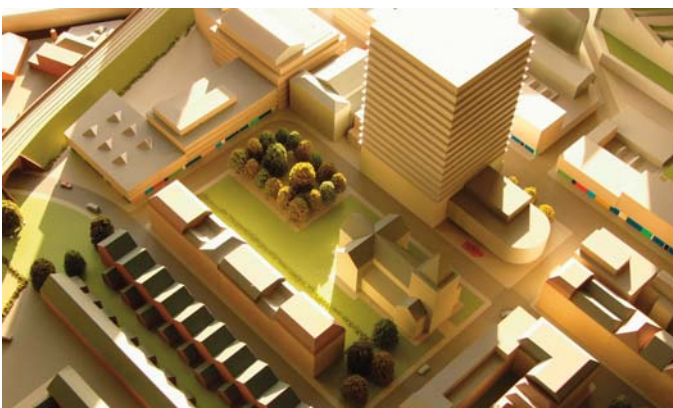

## Advice and guidance

CSE can provide expert support via email and telephone to assist community groups with specific issues and questions about their projects, including: technical queries; planning regulations; project management; community engagement; legal and governance issues; finance and funding.

## Event support

Our free resources are designed to help you run your own events independently of external support. We are also able to attend events if you would prefer to have expert support to hand to address any issues or questions that arise. Other support available includes: assistance with running public meetings on renewable energy; arranging talks from expert speakers; providing materials and resources for groups to run events; or tailoring presentations for specific topics.

## Technical assessment

CSE has extensive technical experience and capability covering the full range of community-scale renewable energy technologies, including solar, wind, hydro, biomass, heat pumps, anaerobic digestion, district heating and Combined Heat and Power (CHP). We undertake site-specific assessments and technology specific feasibility studies including advising on specifications, installation and financing options (including the Feed-in Tariff and the Renewable Heat Incentive).

We also provide building energy audits and advise on energy efficiency and energy management issues.

**Please note that in-depth support to individual community groups (e.g. advice, event support and technical assessments) is dependent on our funding.**

**We aim to secure funds to offer free support wherever possible, or to direct you to free resources or other appropriate organisations in your area who may be able to help. We will usually need to charge for in-depth support outside our funded programmes.**

CSE's past and current community projects are profiled at [www.cse.org.uk/projects-community](http://www.cse.org.uk/projects-community).

Please contact us by phone (0117 934 1400) or email ([communities@cse.org.uk](mailto:communities@cse.org.uk)) for information on our funded community projects or to discuss bespoke support.

Follow CSE Communities on Twitter: [@cse\\_communities](https://twitter.com/cse_communities)



3 St Peter's Court  
Bedminster Parade  
Bristol  
BS3 4AQ

[www.cse.org.uk](http://www.cse.org.uk)  
0117 934 1400  
charity 298740